

FOR LEASE OFFICE / WAREHOUSE

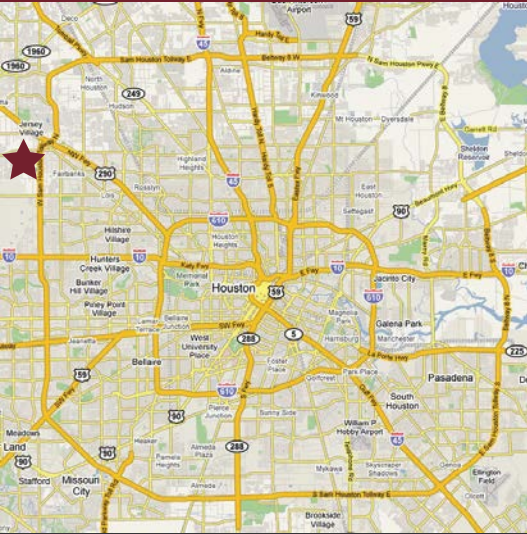

For further information
please contact:

Charlie Christ / Robert Clay
P 713.789.2529
F 713.782.3755
cchrist@claydevelopment.com

FEATURES

- 15,000 sf building including 5,085 sf offices and 9,915 sf warehouse
- Located at Cunningham Business Park, off of Cunningham Road just South of W Little York in NW Harris County.
- Excellent Access to Beltway 8, I-10 and Hwy 290
- 10 ton crane ready, 24 ft. eave height

CLAY
DEVELOPMENT & CONSTRUCTION INC.
COMMERCIAL DESIGN-BUILDERS



**6431 CUNNINGHAM ROAD
CUNNINGHAM BUSINESS PARK**



FOR LEASE OFFICE / WAREHOUSE

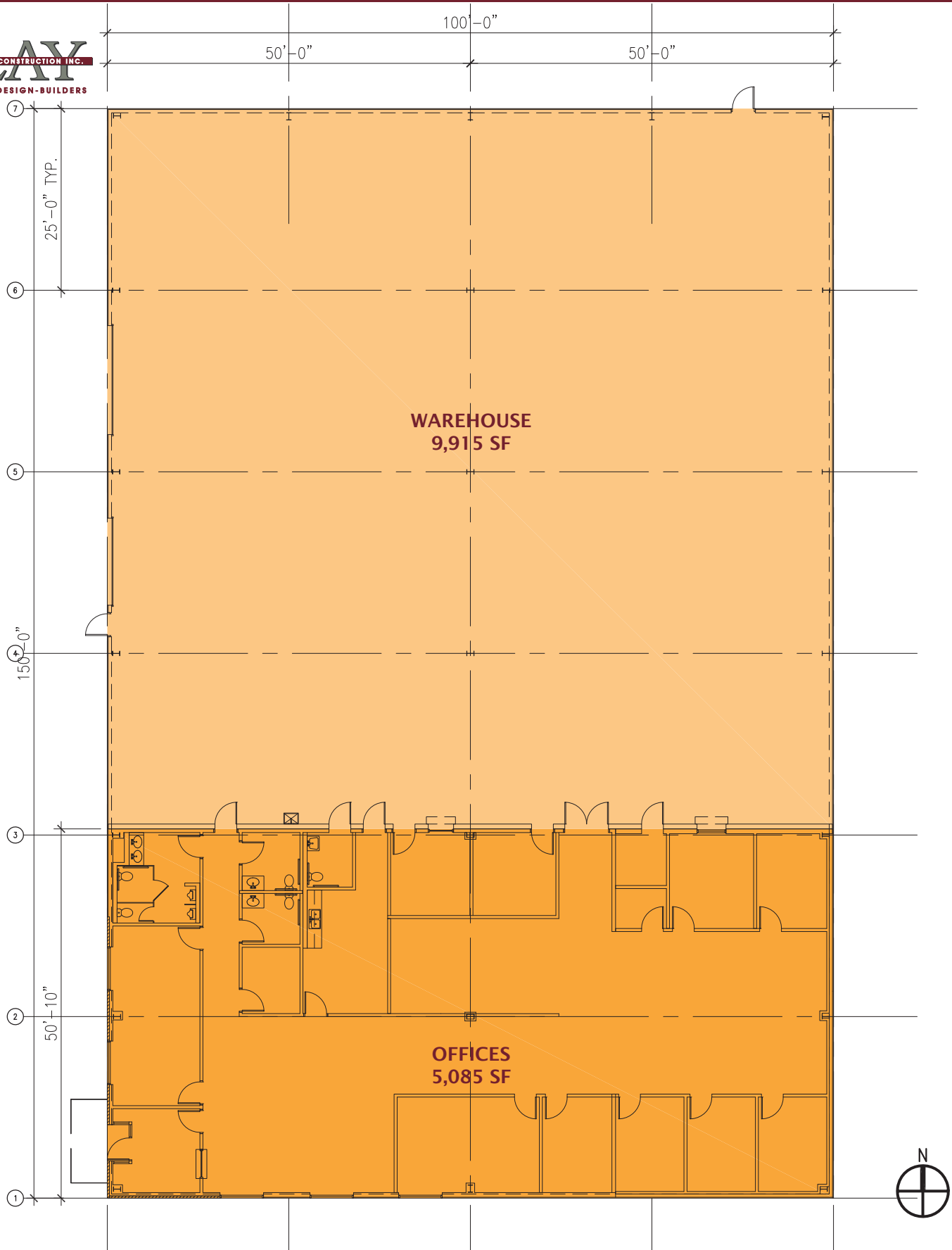

**6431 CUNNINGHAM ROAD
CUNNINGHAM BUSINESS PARK**