

FOR LEASE OFFICE / WAREHOUSE

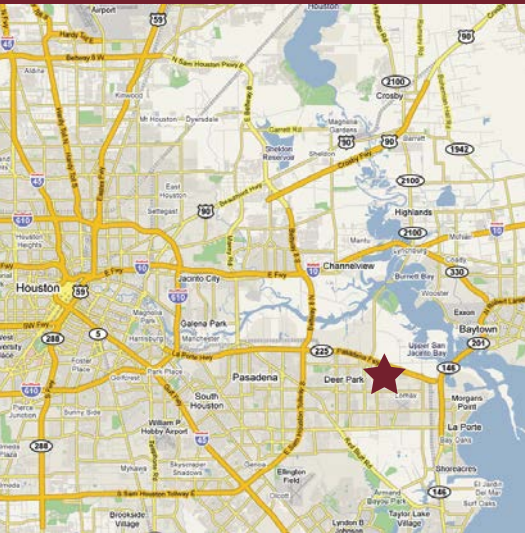

For further information
please contact:

Copeland Rhea / Charlie Christ
P 713.789.2529
F 713.782.3755
cchrist@claydevelopment.com

FEATURES

- 17,000 sf lease space including 9,015 sf warehouse and 7,985 sf offices
- Excellent access to SH 225, Barbour's Cut, SH 146 and Beltway 8
- City of La Porte utilities, foreign trade zone designation
- 24' eave height
- Fully sprinklered building
- Deed restricted park w/ professional management

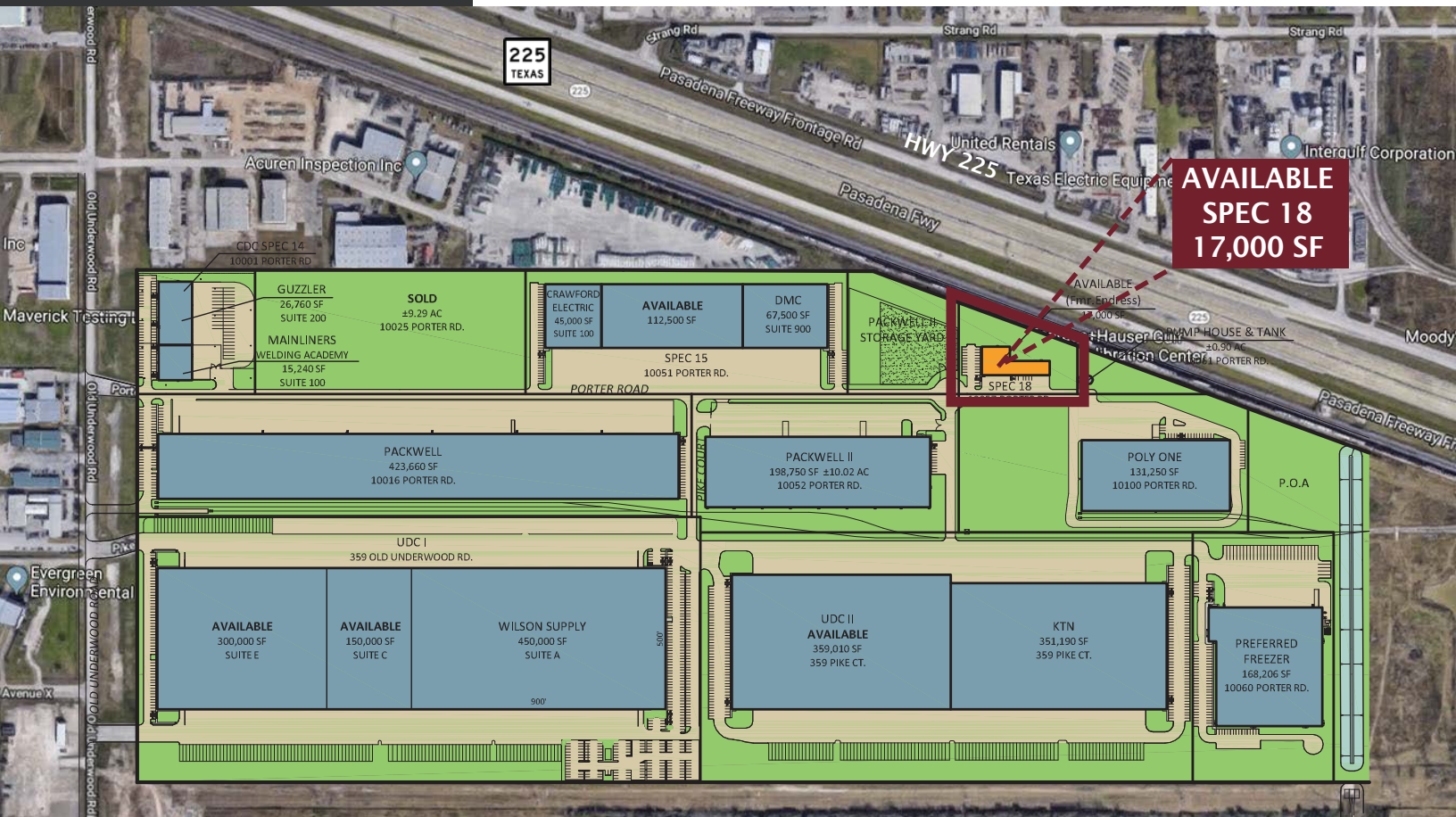

10057 PORTER ROAD UNDERWOOD BUSINESS PARK



FOR LEASE OFFICE / WAREHOUSE

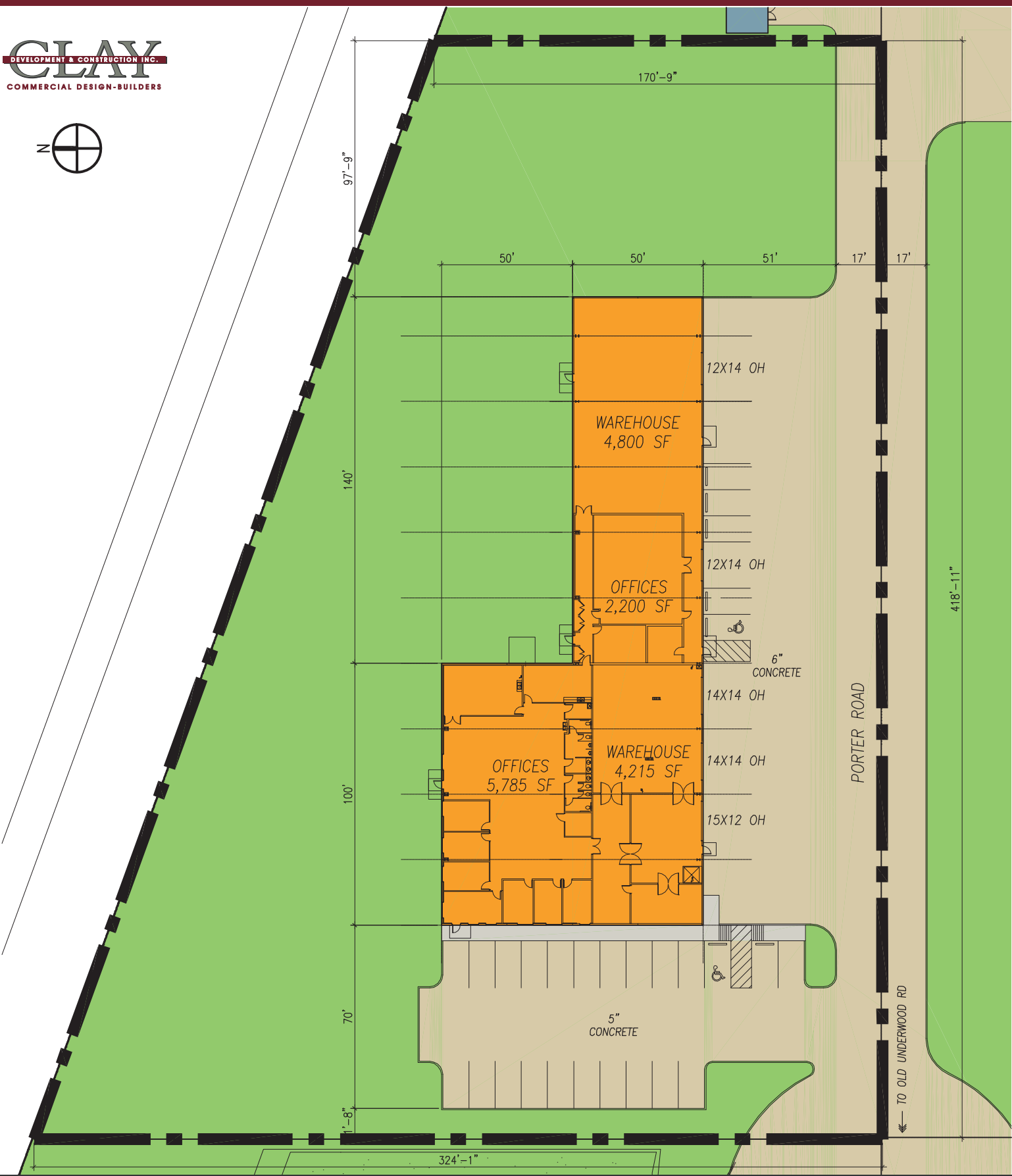

**10057 PORTER ROAD
UNDERWOOD BUSINESS PARK**