

THOMAS RD BUSINESS PARK PHASES I & II

HARRIS COUNTY, TEXAS
LAND ± 561,105 SQ. FT. ~12.88 AC.

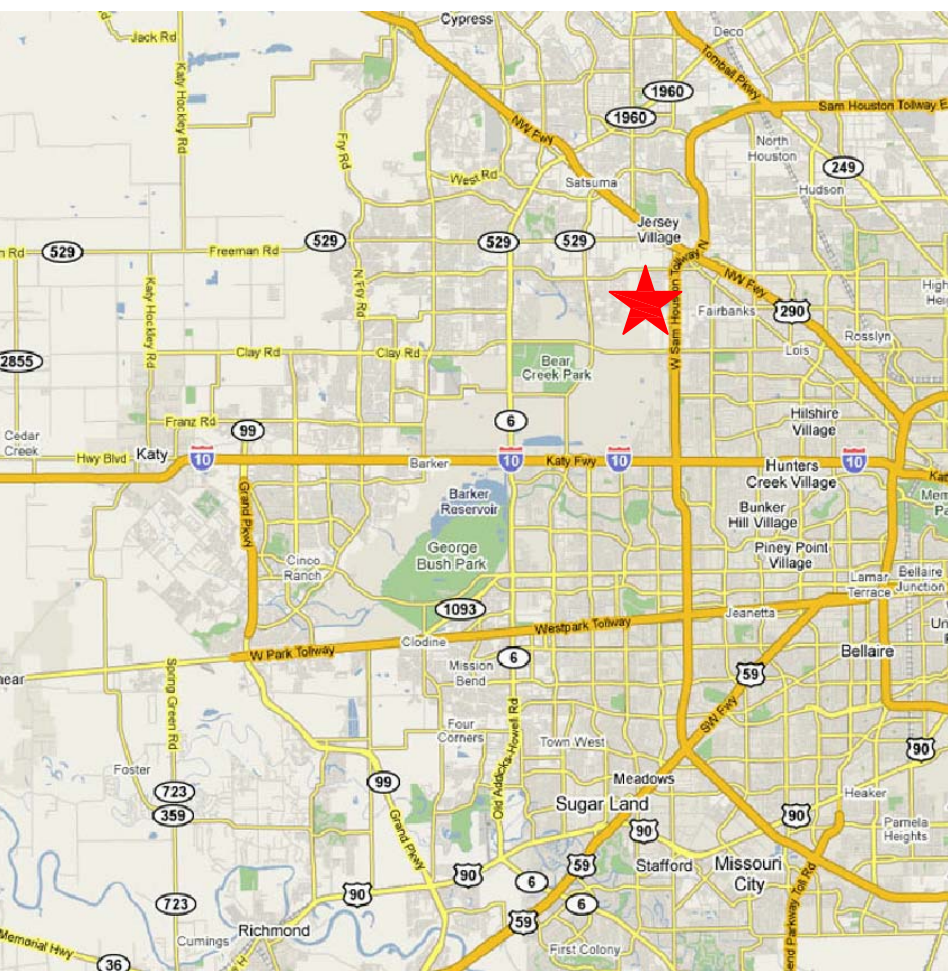

KEY

- LEASE SPACE AVAILABLE
- LAND AVAILABLE
- PROPOSED BUILDING / LAND AVAILABLE
- LEASED/SOLD BUILDING

SITE PLAN



5599 SAN FELIPE, SUITE 1440
HOUSTON, TX 77057
PHONE (713)789-2529
FAX (713)782-3755

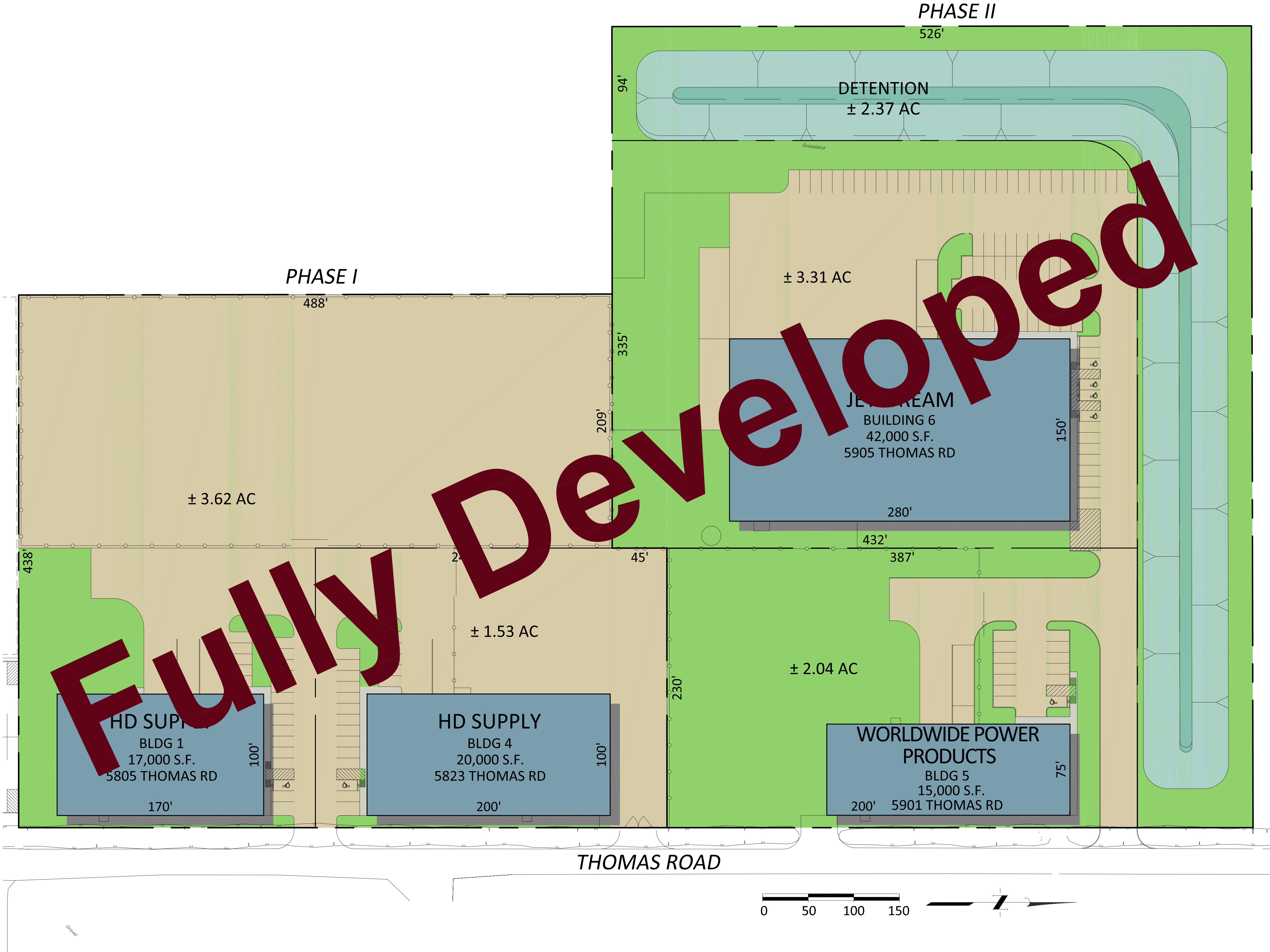

Fully Developed