

FOR LEASE OFFICE / WAREHOUSE

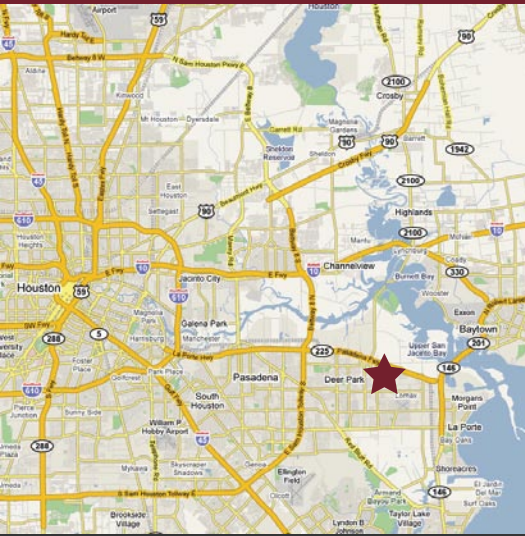

For further information
please contact:

Charlie Christ / Robert Clay
P 713.789.2529
F 713.782.3755
cchrist@claydevelopment.com

FEATURES

- 42,000 sf building including 37,330 sf warehouse and 4,670 sf offices
- Excellent access to SH 225, Barbour's Cut, SH 146 and Beltway 8
- City of La Porte utilities, foreign trade zone designation
- 24' eave height, 25' X 60' bay spacing
- 10 ton crane ready building w/ (1) 10 ton crane
- Fenced outside storage; additional land available



**10001 PORTER ROAD
UNDERWOOD BUSINESS PARK**



FOR LEASE OFFICE / WAREHOUSE

***CRANE READY:**
STRUCTURE IS SIZED TO
ACCOMMODATE A FUTURE
CRANE, NO CRANE OR
CRANE BEAMS ARE
PROVIDED

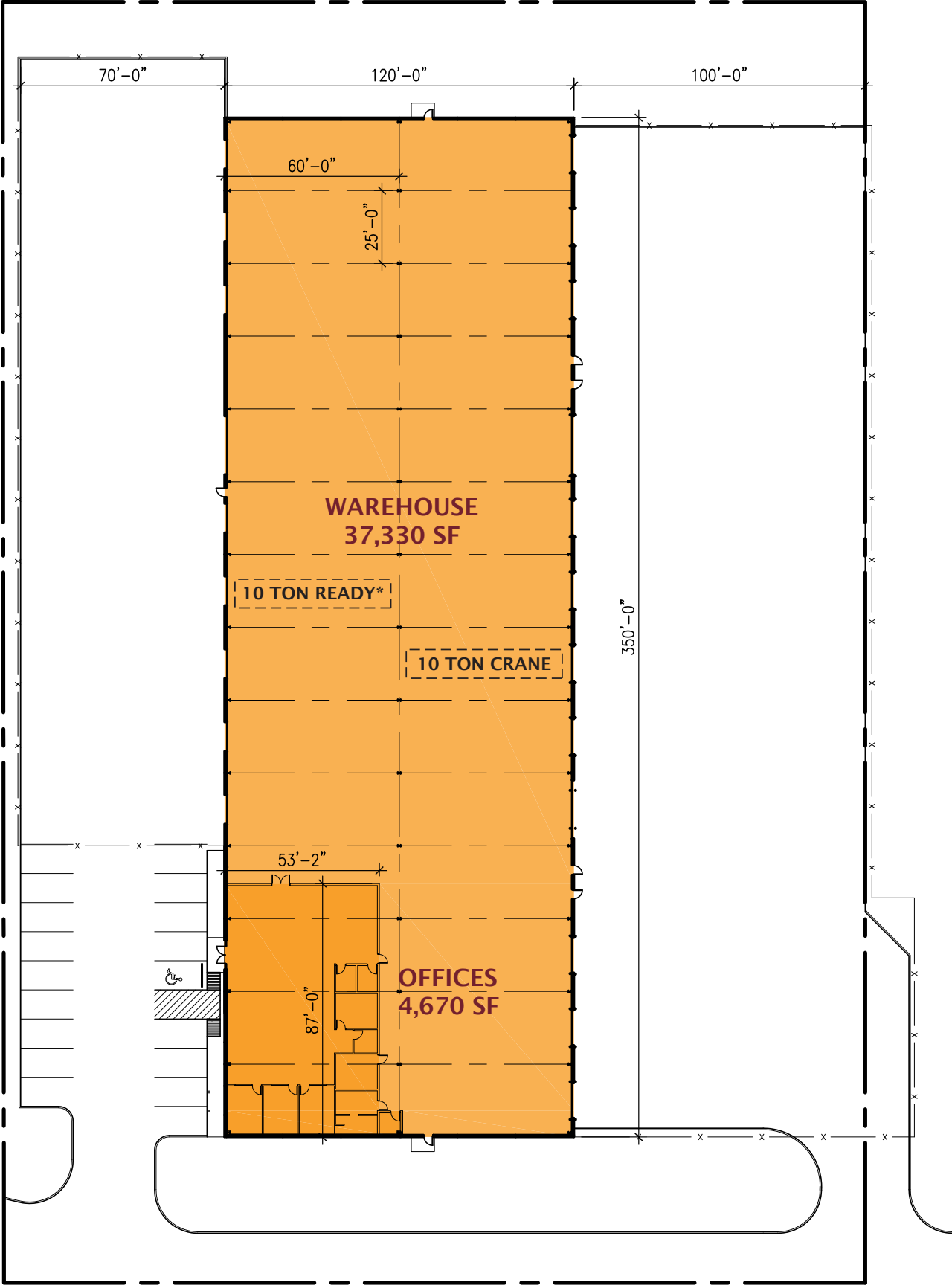

**10001 PORTER ROAD
UNDERWOOD BUSINESS PARK**